

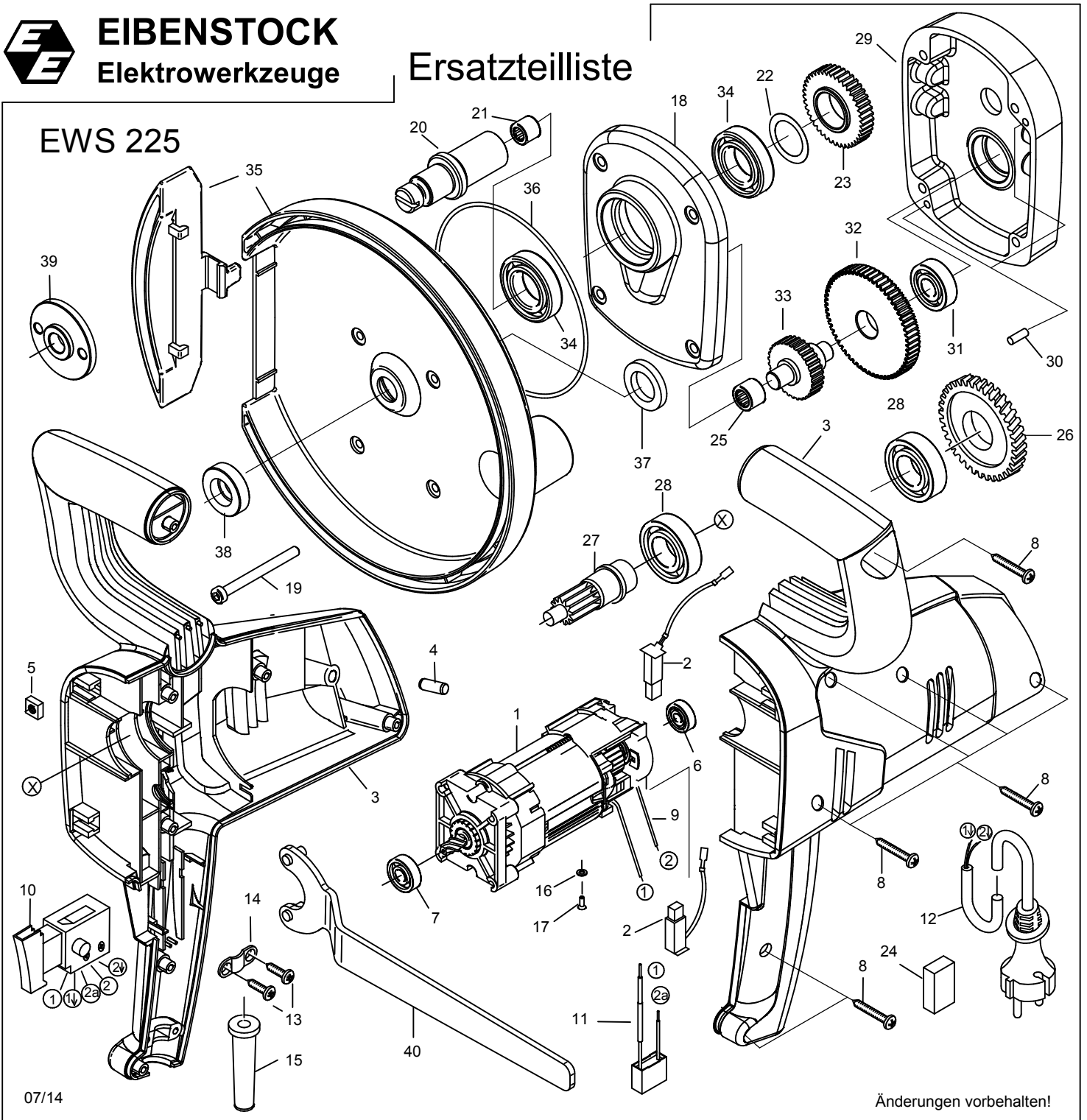

**EIBENSTOCK**  
Elektrowerkzeuge

## Ersatzteilliste

EWS 225



07/14

Änderungen vorbehalten!

# EWS 225 - 230 V

0620D000

| Nr. | Bezeichnung                  | Bestellnr. | Stk | Nr. | Bezeichnung               | Bestellnr. | Stk |
|-----|------------------------------|------------|-----|-----|---------------------------|------------|-----|
| 1   | Motor                        | 75502100   | 1   | 21  | Nadelhülse HK0810         | 80420110   | 1   |
| 2   | Kohlebürste, kpl. 5x8        | 80700035   | 2   | 22  | Paßscheibe 20/28x0,1      | 80200509   | 1   |
| 3   | Motorgehäuse                 | 80900163   | 1   | 23  | Spindelrad                | 7620D430   | 1   |
| 4   | Silikonstopfen 6x15          | 80901055   | 2   | 24  | Füllstück                 | 80600306   | 1   |
| 5   | Vierkantsmutter M5           | 80201031   | 4   | 25  | Nadelhülse HK1010         | 80420115   | 1   |
| 6   | Rillenkugellager 626 2RSL C3 | 80410025   | 1   | 26  | Stirnrad                  | 75502471   | 1   |
| 7   | Rillenkugellager 608 2RSL C3 | 80410026   | 1   | 27  | Welle mit Ritzel          | 77011500   | 1   |
| 8   | Blechschrabe 4,2x19 Torx     | 80201229   | 7   | 28  | Rillenkugellager 6003 2RS | 80410043   | 2   |
| 9   | Anschlußlitze                | 80600077   | 2   | 29  | Getriebelagerschild       | 7620D610   | 1   |
| 10  | Einbauschalter               | 80600135   | 1   | 30  | Steckerbstift 4x12        | 80200582   | 2   |
| 11  | Entstörkondensator 0,22 µF   | 77018305   | 1   | 31  | Rillenkugellager 6000 2RS | 80410023   | 1   |
| 12  | Anschlußleitung, kpl. 5m     | 80600245   | 1   | 32  | Zwischenrad               | 76507470   | 1   |
| 13  | Blechschrabe HC 4,2x9,5      | 80201269   | 2   | 33  | Zwischenwelle             | 7620D480   | 1   |
| 14  | Zugentlastungsschelle        | 85000020   | 1   | 34  | Rillenkugellager 6904 2RS | 80410152   | 2   |
| 15  | Kabelausführungsmuffe        | 83000004   | 1   | 35  | Gehäuse, kpl.             | 7620D57U   | 1   |
| 16  | Scheibe 4,3                  | 80201371   | 2   | 36  | O-Ring 160x2              | 83000092   | 1   |
| 17  | Blechschrabe 2,9x9,5         | 80201251   | 2   | 37  | Filzring                  | 83000500   | 1   |
| 18  | Getriebegehäuse              | 7620D400   | 1   | 38  | Schleiftelleraufnahme     | 76203933   | 1   |
| 19  | Linsenschraube M5x60         | 80201368   | 4   | 39  | Spannmutter               | 76203935   | 1   |
| 20  | Arbeitsspindel               | 7620D420   | 1   | 40  | Stirnlochschlüssel        | 80430042   | 1   |

**EWS 225 - 230 V**

0620D000

| No. | Description                            | Order No. | Pcs | No. | Description                   | Order No. | Pcs |
|-----|--|-----------|-----|-----|-------------------------------|-----------|-----|
| 1   | motor                                  | 75502100  | 1   | 21  | needle sleeve HK 0810         | 80420110  | 1   |
| 2   | carbon brush 5x8x14                    | 80700035  | 2   | 22  | fitting washer 20/28x0,1      | 80200509  | 1   |
| 3   | motor housing                          | 80900163  | 1   | 23  | spindle wheel                 | 7620D430  | 1   |
| 4   | silicone plug                          | 80901055  | 2   | 24  | foam filler                   | 80600306  | 1   |
| 5   | square M5                              | 80201031  | 4   | 25  | needle sleeve HK 1010         | 80420115  | 1   |
| 6   | grooved ball bearing 626 2RSL C3       | 80410025  | 1   | 26  | intermediate wheel            | 75502471  | 1   |
| 7   | grooved ball bearing 608 2RSL C3       | 80410026  | 1   | 27  | shaft                         | 77011500  | 1   |
| 8   | self tapping screw 4,2x19 Torx         | 80201229  | 7   | 28  | grooved ball bearing 6003 2RS | 80410043  | 2   |
| 9   | pigtail                                | 80600077  | 2   | 29  | end shield of gearing         | 7620D610  | 1   |
| 10  | switch                                 | 80600135  | 1   | 30  | notched pin plug 4x12         | 80200582  | 2   |
| 11  | anti parasite condenser 0,22 µF        | 77018305  | 1   | 31  | grooved ball bearing 6000 2RS | 80410023  | 1   |
| 12  | connecting cable 2x1 <sup>2</sup> , 5m | 80600245  | 1   | 32  | intermediate wheel            | 76507470  | 1   |
| 13  | self tapping screw HC 4,2x9,5          | 80201269  | 2   | 33  | intermediate shaft            | 7620D480  | 1   |
| 14  | wire locking flange                    | 85000020  | 1   | 34  | grooved ball bearing 6904 2RS | 80410152  | 2   |
| 15  | cable grommet                          | 83000004  | 1   | 35  | housing                       | 7620D57U  | 1   |
| 16  | disc A4,3                              | 80201371  | 2   | 36  | o-ring 106x2                  | 83000092  | 1   |
| 17  | self tapping screw HC 2,9x9,5          | 80201251  | 2   | 37  | felt ring 27x17x4             | 83000500  | 1   |
| 18  | gearbox housing                        | 7620D400  | 1   | 38  | grinding disc                 | 76203933  | 1   |
| 19  | lens head screw M5x60                  | 80201368  | 4   | 39  | clamp nut                     | 76203935  | 1   |
| 20  | work spindle                           | 7620D420  | 1   | 40  | face spanner                  | 80430042  | 1   |